

65W 2~3 Output Switching Power Supply

- Universal AC input / Full range
- Protections: Short circuit / Overload / Over voltage
- Cooling by free air convection
- 12V or 24V high peak current capability
- 60~65W free air convection, 77~80W with 18 CFM forced air
- Low leakage current < 1mA
- 100% full load burn-in test
- **Optional case available (RPD/RPT-65x-C)**
- 2 years warranty capability

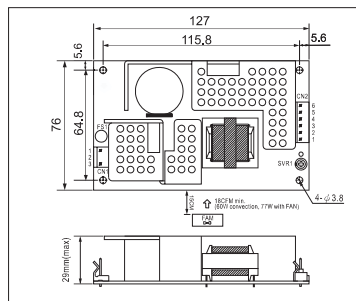

► With Optional Case

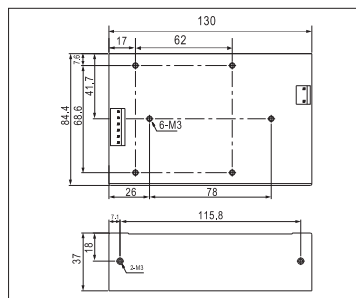

- AC input voltage range 90~264VAC; 127~370VDC
- AC inrush current Cold start, 25A at 115VAC, 50A at 230VAC
- DC adjustment range CH1 12V: 11.4~12.8V, 24V: 22.8~26.4V
- Overload protection 90~125W hiccup mode, auto-recovery
- Over voltage protection CH1: 115%~135% rated output voltage
- Leakage current Less than 1mA at 240VAC
- Setup, rise, hold up time 800ms, 20ms, 20ms at full load and 230VAC
- Withstand voltage I/P-O/P: 3kVAC, I/P-FG:1.5kVAC, 1minute
- Working temperature -20~60°C(refer to output derating curve)
- Safety standards UL60950-1, TUV EN60950-1 approved
- EMC standards EN55022 class B, EN61000-3-2,3, EN61000-4-2,3,4,5,6,8,11, ENV50204
- Connection 3P, 6P/ 3.96mm pitch, Molex P/N: 5273-03, 5273-06
- Packing 0.24kg ; 63pcs / 16.0kg / 1.35CUFT

❖ Dual Output

Model No.	Output	Tol.	R&N	Effi.	Max.
RPD-65C □	12V, 0~5.8A	±2%	120mV	79%	60W
	5V, 0~1.5A	±5%	50mV		
RPD-65D □	24V, 0~2.9A	±2%	150mV	81%	60W
	5V, 0~1.5A	±5%	50mV		

❖ Triple Output

Model No.	Output	Tol.	R&N	Effi.	Max.
RPT-65E □	12V, 0.18~5.8A	±2%	120mV	77%	63W
	5V, 0.0~1.5A	±5%	100mV		
	-5V, 0.0~0.7A	±5%	120mV		
RPT-65F □	12V, 0.18~5.8A	±2%	150mV	77%	66W
	5V, 0.0~1.5A	±5%	100mV		
	-12V, 0.0~0.7A	±5%	150mV		
RPT-65G □	24V, 0.09~2.9A	±2%	150mV	81%	66W
	5V, 0.0~1.5A	±5%	50mV		
	12V, 0.0~0.7A	±5%	100mV		

□ = blank, -C ; blank: PCB Type, -C: Enclosed Type